



COMPEL
COMPEL ELECTRONICS S.p.A.

CONNETTORI COASSIALI 1.0/2.3 COAXIAL CONNECTORS

Connettore maschio volante.
Sistema d'accoppiamento : scatto autobloccante.
Conforme a norme DIN 47297 e CECC 22230
Impedenza : 50Ω

Free plug.
Coupling type : push-pull.
According to DIN 47297 and CECC 22230
Impedance : 50Ω

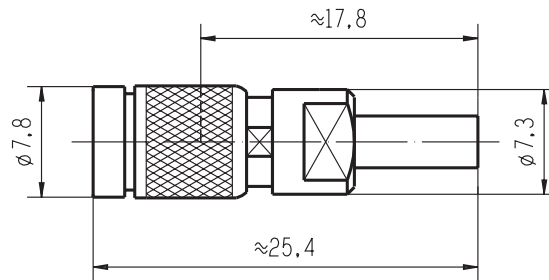

Part. nr.	Cavo/ Cable	∅ ext.	CH/ HEX (A)
350.044.054	ST 121 (75Ω)	4,8 max.	5,41
350.044.055	RG 179 B/U (75Ω)	2,54 ±0.127	3,2
	RG 187 A/U (75Ω)	2,79 max.	
	RG 188 A/U (50Ω)	2,79 max.	
	RG 316/U (50Ω)	2,49 ±0.1	

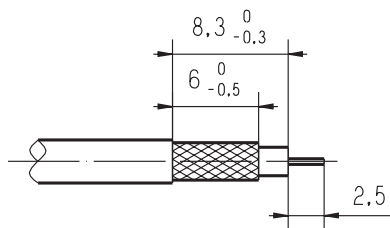

Sistema di attacco al cavo

Contatto interno : a saldare

Contatto esterno : a crimpare con esagono dimensione (A) e lunghezza di crimpatura 7#8.

Cable attachment

Inner contact : soldering

Outer contact : crimping - die closure dimension HEX (A) and length of crimping 7#8

ED.	DATA/ DATE	FIRMA / SIGN.	ED.	DATA/ DATE	FIRMA / SIGN.	ED.	DATA/ DATE	FIRMA / SIGN.
01	26.10.92	Mm Eb	04	12.05.94	Cv Eb			
02	28.01.93	Cv Eb	05	11.01.00	Gb Cv			
03	02.03.93	Cv Eb						

COMPEL RESERVES THE RIGHT TO MODIFY ITS SPECIFICATIONS WITHOUT PRIOR MODIFICATION AND DISTRIBUTION.

LE CARATTERISTICHE ELENATE POSSONO ESSERE SOGGETTE A MODIFICHE SENZA ALCUN OBBLIGO DI PREAVVISO E DISTRIBUZIONE.

DC.044.054