



COMPEL
COMPEL ELECTRONICS S.p.A.

CONNETTORI COASSIALI 1.0/2.3 COAXIAL CONNECTORS

Connettore maschio volante.
Sistema d'accoppiamento : scatto autobloccante.
Conforme a norme DIN 47297 e CECC 22230
Impedenza : 50Ω

Free plug.
Coupling type : push-pull.
According to DIN 47297 and CECC 22230
Impedance : 50Ω

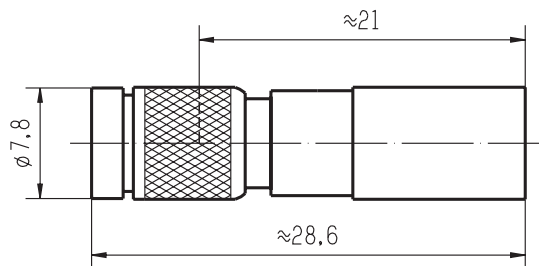

Part. nr.	Cavo/ Cable	∅ ext.
350.044.051	ST 214 (75Ω)	5.9 max.
	RG 59B/U	6.15 ±0.1

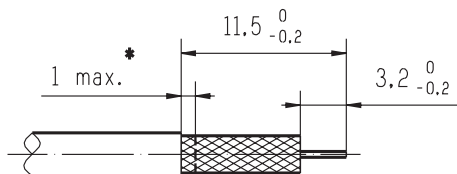

* Tagliare il nastro intermedio alla quota indicata.
Trim the intermediate foil to the indicated dimension.

Sistema di attacco al cavo

Contatto interno : a saldare o a crimpare con quadro 1 e lunghezza di crimpatura 2,5 (per ST 214)
a saldare (per RG 59B/U)

Contatto esterno : a crimpare con esagono 6,8 e lunghezza di crimpatura 10.

Cable attachment

*Inner contact : soldering or crimping - die closure dimension square 1 and length of crimping 2.5 (for ST 214)
soldering (for RG 59B/U)*

Outer contact : crimping - die closure dimension HEX 6.8 and length of crimping 10

ED.	DATA/ DATE	FIRMA / SIGN.	ED.	DATA/ DATE	FIRMA / SIGN.	ED.	DATA/ DATE	FIRMA / SIGN.
01	05.4.93	Mm Eb						
02	12.12.96	Gb Eb						
03	11.01.00	Gb Cv						